

WWH10-108ATV3*

Megapixel Telecentric Lens

- Compact design with coaxial illumination options;
- Perfect image and supports all kinds of Mega camera;
- High contrast, low distortion, high resolution;
- Optional adjustable Iris for resolution and DOF control;
- Megapixel 'object side' telecentric lens with optional long working distance versions with over 500mm working distance.



| Optical Specifications | |
|------------------------------------|----------|
| Magnification (x) | 1.0 |
| Working Distance (mm) | 108 |
| Max Sensor Size (Φmm) | 11(2/3") |
| Aperture (F/#) | 7.0 |
| Telecentricity typical (max) (deg) | 0.05 |
| Distortion typical (max) (%) | 0.04 |
| NA | 0.0712 |
| Resolution (μm) | 4.7 |
| Depth of Field (mm) | 0.6 |

| Field of View (mm × mm) | |
|----------------------------|-----------|
| 1/2"(6.4×4.8) | 6.4×4.8 |
| 1/1.8"(7.13×5.37) | 7.13×5.37 |
| 2/3" IMX250/264 (8.45×7.1) | 8.45×7.1 |
| Mechanical Specifications | |
| Mount | C |
| Length (mm) | 105.1 |
| Coaxial Light | No |
| Iris | No |

Notes:

1. Depth of Field is calculated value, this value could be used for imaging test, but to get sharp image in application, half of calculated value is suggested.

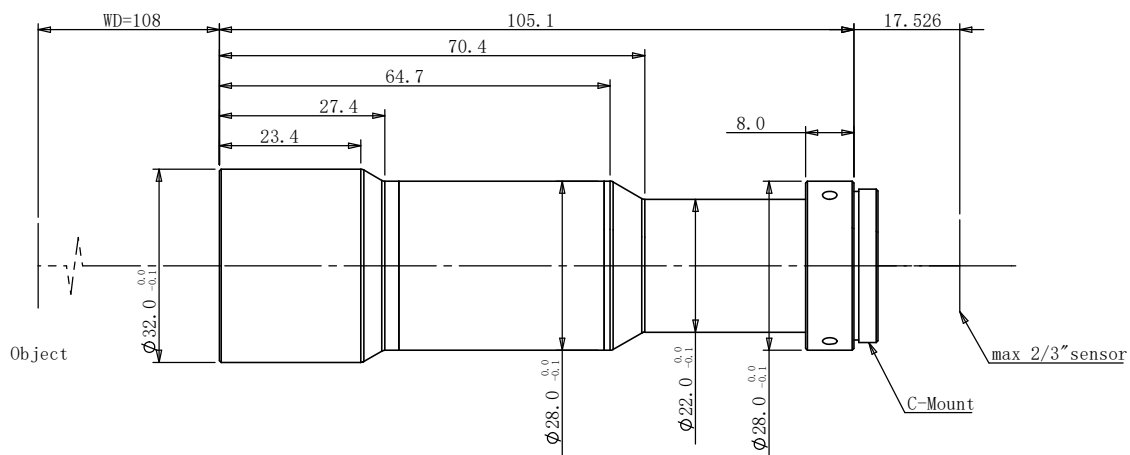

Note: * New product.