

RL06130D SPECIFICATION

- The Chart Size is calculated according to the maximum field Angle of the relay lens;
- WDV: Working Distance between the Visual Image of Chart and CCM top;
- WDC: Working Distance between the Chart and Relaylens Object End;
- MDR: Mounting Distance for Relay Lens from CCM top;
- TOTR: Distance from the camera module to the test card.
- The length and width of chart are calculated according to the chip specifications 4:3 or 16:9 of the camera module.

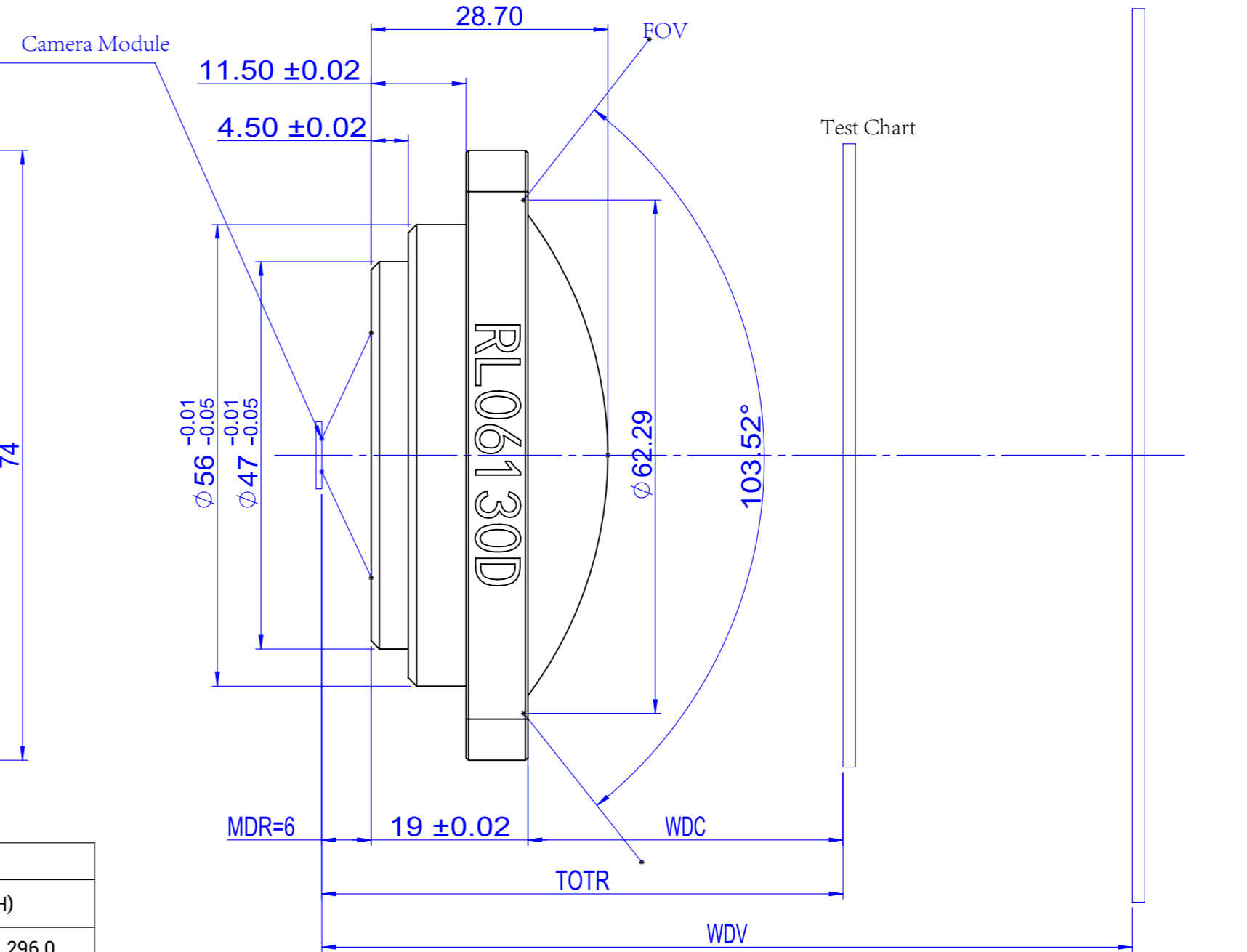
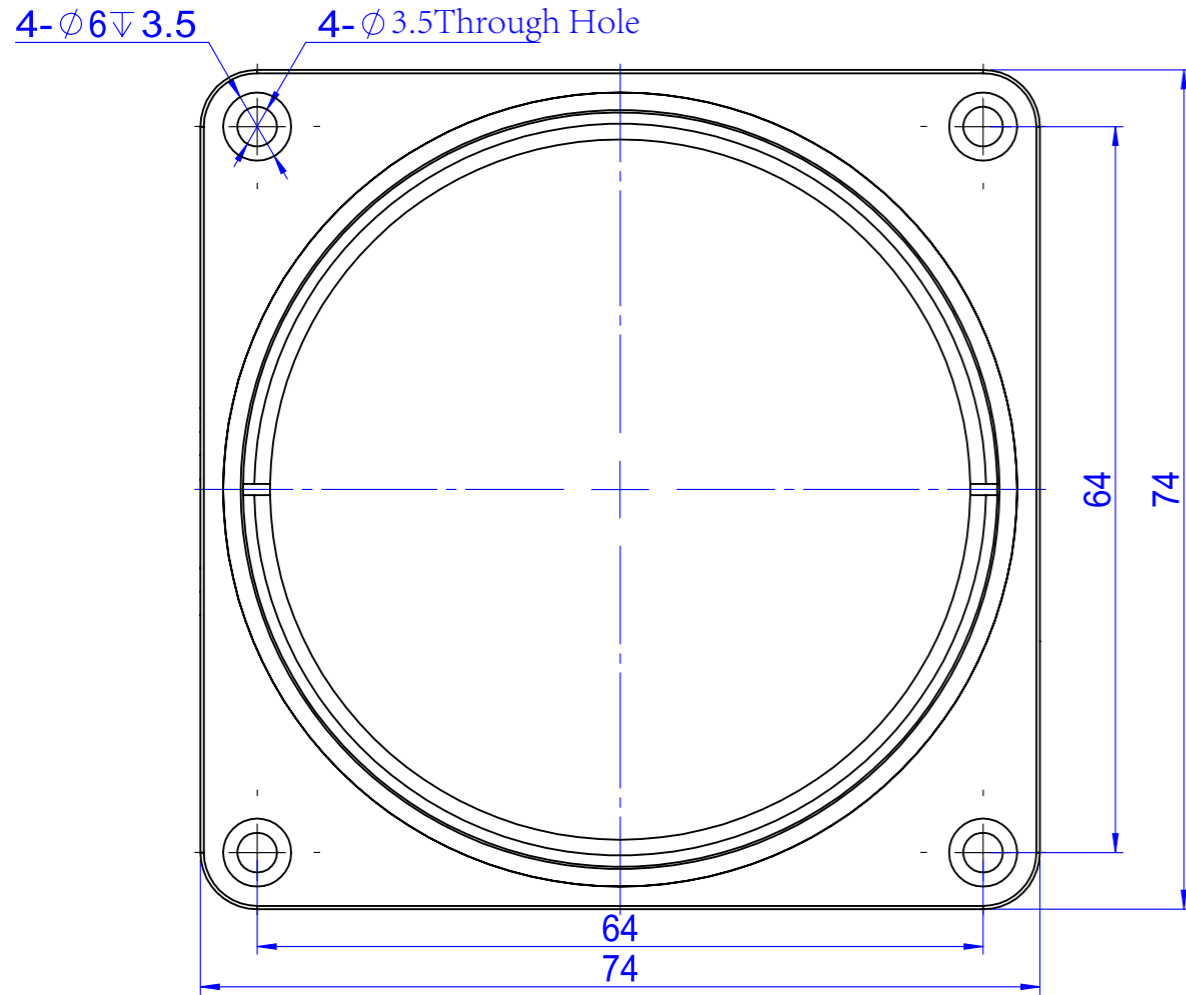

Visual Image of Test Chart

WDV	WDC	TOTR	Chart Size@Max FOV				
			Diagonal	4:3(WxH)		16:9(WxH)	
500	211.44	236.4361	603.7	483.0	362.2	526.2	296.0
800	244.28	269.2786	688.2	550.6	412.9	599.8	337.4
1000	257.38	282.3843	721.9	577.5	433.2	629.2	353.9
2000	287.90	312.8953	800.4	640.4	480.3	697.7	392.4
3000	299.60	324.6046	830.6	664.5	498.3	723.9	407.2
5000	309.63	334.6298	856.4	685.1	513.8	746.4	419.9
8000	315.55	340.5488	871.6	697.3	523.0	759.7	427.3
10000	317.57	342.5692	876.8	701.4	526.1	764.2	429.9
50000	324.20	349.2	893.9	715.1	536.3	779.1	438.2
100000	325.05	350.0472	896.1	716.8	537.6	781.0	439.3

Focal Length	300
Distortion	<30%
MAX FOV	130°
Weight	0.23 [Ⓐ]
Exit Pupil Aperture	4
MDR	6
Wavelength	420-940 nm

Lontry		DESIGN	Derek	2020.6.22	MACHINE MODEL:	RL06130D		
INFORMATION HEREIN SHALL NOT BE REPRODUCED IN ANY FORM WITHOUT COLIBRI WRITTEN PERMISSION		CHECKED			TITLE: RL06130D SPECIFICATION			
TOLERANCE CLASS NOT SPECIFIED		APPROVED			MATERIAL: Product		QTY	TREATMENT
Dimensional tol./Masstol. ISO 2768-1:1999	tol.-class/Tol.-k.	SCALE	A3	UNIT	mm	DWG/N	REV.	A
Geometrical tol./Form-u. Lagetol. ISO 2768-2:1999	tol.-class/Tol.-k.	SCALE	1:2	WT(kg)	0.23		SHEET	1/1